



# SOUNDWALL™ INWALLS

CINEMA SERIES

MUSIC HALL SERIES

X-BASE SERIES

POWERSLIM SERIES

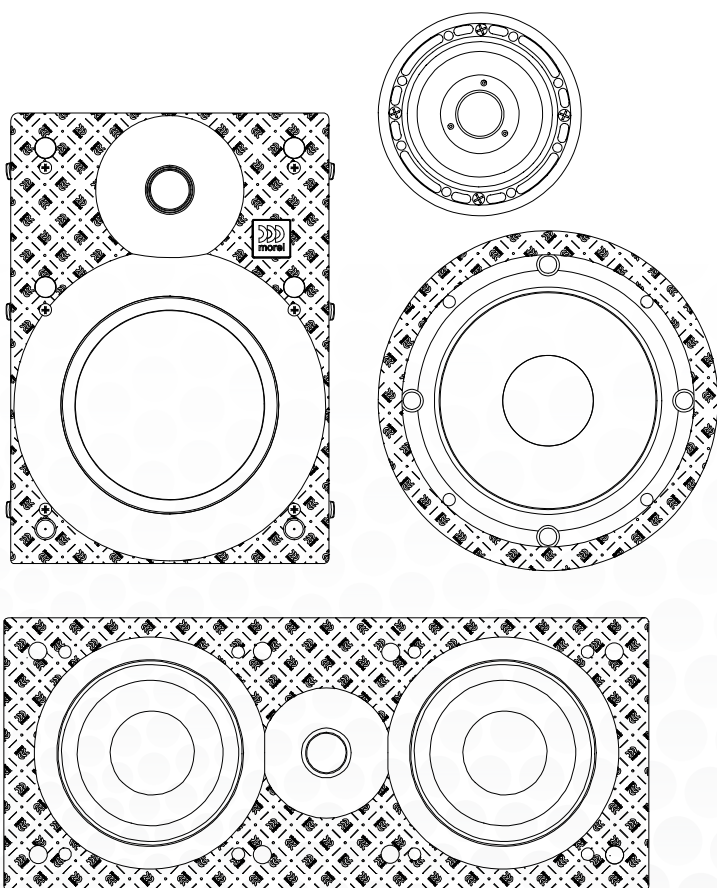

User Manual and Installation Guide

# Introduction

Dear Customer,  
Thank you for choosing Morel's SoundWall™ speaker!

These handcrafted speakers are uniquely designed and constructed to offer extraordinary sound quality for both stereo and home theatre applications. When properly installed the Sound the SoundWall™ speakers will transform your musical and cinematic experience into true magic, for your long lasting enjoyment.

The information in this manual will help you get the best possible performance out of your speakers. If you have any questions, please contact your Morel dealer, or Morel Support at [www.morelhifi.com](http://www.morelhifi.com)

## Speaker placement

The position of the speakers has a great effect on the quality of the sound and soundstage created. Here are some recommended guidelines that will assist you in the speaker placement process.

Morel SoundWall™ speakers are designed to work well in both small and large rooms.

Regardless of the application you may require it is recommended to make sure there are no objects that may block the area between the listener and the speakers.

Before installing the speakers consider the proximity to the electricity and other fixtures.

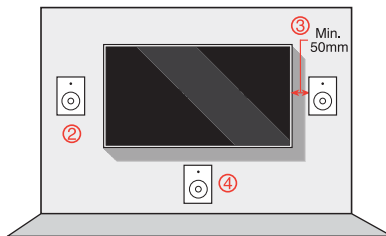
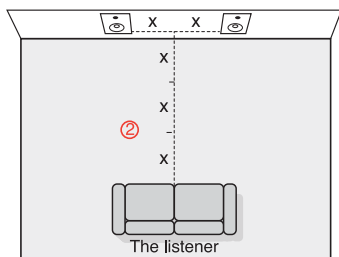

### Recommended speaker placement for stereo application

#### Ideally:

- ① The tweeter should be at ear level
- ② The distance between the speakers is  $\frac{2}{3}$  the distance from the listener
- ③ Aim to set the speaker as close as possible to this diagram for optimal performance

### Recommended speaker placement for home theatre

- ① Place the speaker on either sides of the flat panel screen
- ② The speaker should be centered to the flat panel screen
- ③ The distance between the edge of the flat panel screen and the speaker should be minimum 50mm
- ④ Preferably place the centre speaker under the flat panel screen

If additional speakers are desired - they should be placed at the same height as the main frontal speakers (if positioned on the side walls)

# Installation preparation

## Insulating the Wall Cavity

To achieve the very best from your loudspeakers we recommend you fill the wall cavity behind the speakers with fibre-glass insulation / Rockwall. It is important to try and keep the same amount of insulation material for each speaker to receive a true consistent bass response.

Install insulation also in the bays adjacent to the speaker location to reduce the noise produced by unsupported drywall. If in doubt, please consult your dealer / installer.

## Back Box

Morel's SoundWall™ speakers infinite baffle design allows you to place them in the wall cavity without the need for an enclosure. Nonetheless, in order to reduce sound transmission to other rooms it is recommended to use a back box / enclosure.

# In-Wall installation

- 1 Marking the wall bracket location using the cardboard template (make sure there is no stud at the back of the drywall)

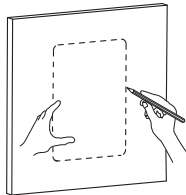

- 2 Cut the wall gently

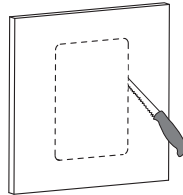

- 3 Connect the cable to the speaker inputs (+) to (+) and (-) to (-)

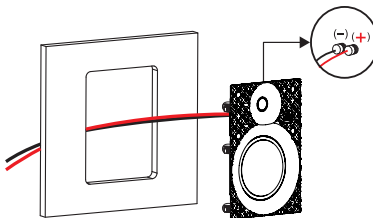

- 4 Use a screw driver to secure frame in the wall

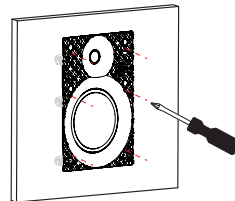

- 5 Set the grille

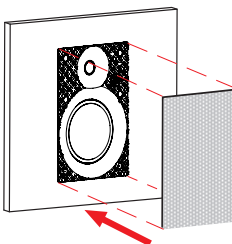

- 6 All done!

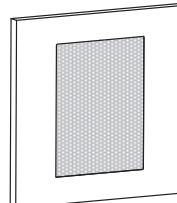

# In-Ceiling installation

- 1 Marking the wall bracket location using the cardboard template (make sure there is no stud at the back of the drywall)

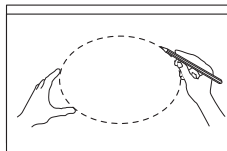

- 2 Cut the wall gently

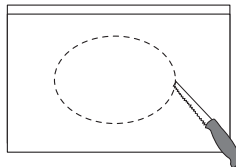

- 3 Connect the cable to the speaker inputs (+) to (+) and (-) to (-)

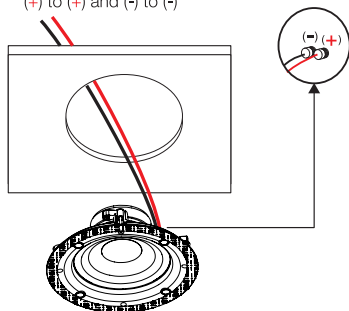

- 4 Use a screw driver to secure frame in the wall

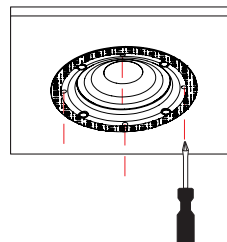

- 5 Set the grille

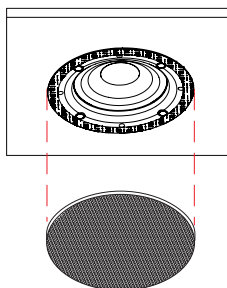

- 6 All done!

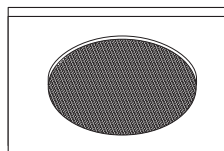

# LCR installation

- 1 Mark the speaker location using the cardboard template (make sure there is no stud at the back of the drywall)

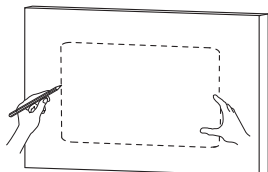

- 2 Cut the wall gently

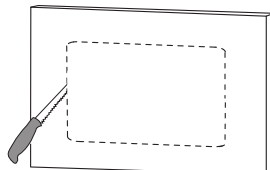

- 3 Connect the cable to the speaker inputs (+) to (+) and (-) to (-)

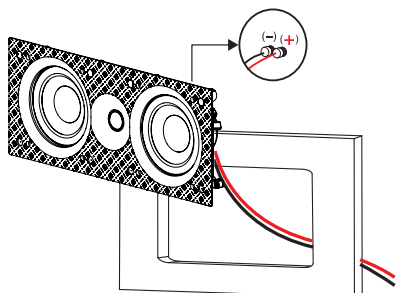

- 4 Use a screw driver to secure frame in the wall (Do not over tighten the screws)

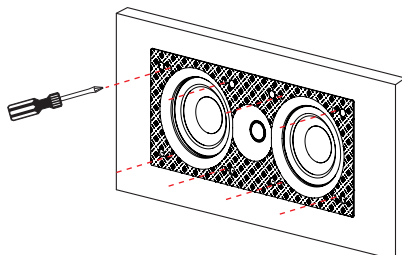

- 5 Set the grille

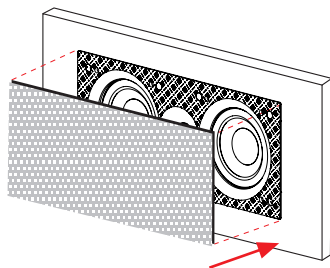

- 6 All done!

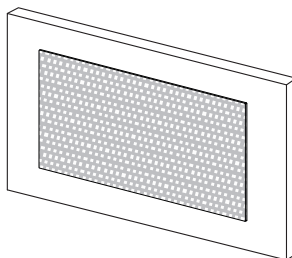

# Specifications

## SoundWall™ XBASE SERIES

Specifications	XBW600	XBW600H	XBW525LCR	XBC600
Construction	Front plastic ABS frame	Front plastic ABS frame	Front plastic ABS frame	Front plastic ABS frame
Drive units	Woofer: 6.5" paper composite cellular fiber cone, 1.1" voice coil, ferrite magnet motor. Tweeter: 1" soft dome, neodymium magnet motor	Woofer: 6.5" paper composite cellular fiber cone, 1.2" voice coil, HYBRID magnet motor. Tweeter: 1" soft dome, neodymium magnet motor	Woofer: 5.25" polypropylene cone, 1" voice coil, ferrite magnet motor. Tweeter: 1" soft dome, ferrite magnet motor	Woofer: 6.5" paper composite cellular fiber cone, 1.1" voice coil, ferrite magnet motor. Tweeter: 1" soft dome, neodymium magnet motor
Nominal impedance	4ohm	4ohm	4ohm	4ohm
Sensitivity 2.83V/1M	90dB	94dB	91dB	90dB
Power handling	90W(RMS)	90W(RMS)	150W(RMS)	70W(RMS)
Operating power	20-100W	10-90W	20-150W	10-70W
Crossover	3,500Hz / 12dB	3,500Hz / 12dB	3,500Hz / 12dB	4,500Hz / 6dB
Frequency response	50-22,000Hz (-5dB)	60-22,000Hz	40-20,000Hz (-5dB)	55-20,000Hz (-5dB)
Grille	Metal	Metal	Metal	Metal
Overall exterior grille dimensions (WxHxD/ø)	8.4"x11.8" (212x300mm)	8.4"x11.8" (212x300mm)	16.6"x7.1"x0.1" (423x180x3mm)	8.9" (228mm)
Cut out dimensions (HxW/ø)	7.3"x10.7" (185x273mm)	7.3"x10.7" (185x273mm)	6.1"x15.4" (154x390mm)	8.1" (206mm)
Mounting Depth	3.15" (80mm)	3.15" (80mm)	3.3" (85mm)	3.15" (80mm)
<b>Grill Finish</b>	white	white	white	white

Specifications	XBC600ST	XBC400	XBW600 AW	XBC600 AW	XBC800 AW
Construction	Front plastic ABS frame	Front plastic ABS frame	Front plastic ABS frame	Front plastic ABS frame	Front plastic ABS frame
Drive units	Woofer: 6.5" paper composite cellular fiber cone, 1.1" dual voice coil, ferrite magnet motor. Tweeter: two 1" soft dome, neodymium magnet motor	Woofer: 4" paper composite cellular fiber cone, 1.1" voice coil, ferrite magnet motor. Tweeter: 1.1" soft dome, neodymium magnet motor	Woofer: 6.5" pp protected cone 1.1" voice coil, ferrite magnet motor. Tweeter: 1" soft dome, neodymium magnet motor	Woofer: 6.5" pp protected cone 1.1" voice coil, ferrite magnet motor. Tweeter: 1" soft dome, neodymium magnet motor	Woofer: 8" pp protected cone 1.1" voice coil, ferrite magnet motor. Tweeter: 1" soft dome, neodymium magnet motor
Nominal impedance	2x4ohm	4ohm	4ohm	4ohm	4ohm
Sensitivity 2.83V/1M	90dB	87.5dB	90dB	90dB	91.5dB
Power handling	50W(RMS)x2	45W(RMS)	90W(RMS)	80W(RMS)	100W(RMS)
Operating power	10-50Wx2	10-45W	20-100W	10-70W	10-100W
Crossover	4,500Hz / 6dB	5,000Hz / 6dB	3,500Hz / 12dB	4,500Hz / 6dB	3,500Hz / 12dB
Frequency response	55-20,000Hz (-5dB)	75-20,000Hz (±3.5dB)	50-22,000Hz (-5dB)	55-20,000Hz (-5dB)	45-20,000Hz (-5dB)
Grille	Metal	Metal + fabric	Metal - water resistant E-Coating	Metal - water resistant E-Coating	Metal - water resistant E-Coating
Overall exterior grille dimensions (WxHxD/ø)	8.9" (228mm)	5.3" (136.4mm)	8.4"x11.8" (212x300mm)	8.9" (228mm)	11.1" (282mm)
Cut out dimensions (HxW/ø)	8.1" (206mm)	4.92" (125mm)	7.3"x10.7" (185x273mm)	8.1" (206mm)	9.7" (246mm)
Mounting Depth	3.15" (80mm)	3.34" (85mm)	3.15" (80mm)	3.15" (80mm)	3.9" (100mm)
<b>Grill Finish</b>	white	white	white	white	white

SoundWall™ MUSIC HALL SERIES

Specifications	MHC600	MHW600	MHW525LCR
Construction	Front plastic ABS frame	Front plastic ABS frame	Front plastic ABS frame
Drive units	<p>Woofer: 6.5" paper composite cellular fiber cone, 2.1" voice coil, aluminum wire.</p> <p>Tweeter: 1.1" soft dome acuflex coated, neodymium magnet motor</p>	<p>Woofer: 6.5" double ferrit magnet motor, one piece integrated dome and surround cone, made of damped polymer composite, 3" aluminum hexatech voice coil.</p> <p>Tweeter: 1.1" aluminum hexatech voice coil, acuflex coated, neodymium magnet motor</p>	<p>Woofer: 5.25" double ferrit magnet motor, one piece integrated dome and surround cone, made of damped polymer composite, 3" aluminum hexatech voice coil.</p> <p>Tweeter: 1.1" aluminum hexatech voice coil, acuflex coated, neodymium magnet motor</p>
Nominal impedance	4ohm	4ohm	4ohm
Sensitivity 2.83V/1M	90dB	90dB	91dB
Power handling	90W(RMS)	120W(RMS)	150W(RMS)
Operating power	10-90W	20-120W	20-150W
Crossover	4,500Hz / 12dB	3,200Hz / 12dB	3,500Hz / 12dB
Frequency response	55-22,000Hz (-5dB)	55-20,000Hz (-5dB)	50-20,000Hz (-5dB)
Grille	Metal basalt grille	Metal basalt grille	Metal basalt grille
Overall exterior grille dimensions (WxHxD/ Ø)	8.9" (228mm)	8.4"x11.8" (212x300mm)	16.6"x7.1"x0.1" (423x180x3mm)
Cut out dimensions (HxW/ Ø)	8.1" (206mm)	7.3"x10.7" (185x273mm)	6.1"x15.4" (154x390mm)
Mounting Depth	3.4" (85mm)	3.4" (85mm)	3.4" (85mm)
Finish	white	white	white

Specifications	MHC400
Construction	Front plastic ABS frame
Drive units	<p>Woofer: 4" driver with 2.1" high temperature aluminum HEXATECH voice coil, neodymium magnet motor.</p> <p>Tweeter: Soft dome 1.1" (28mm) voice coil, neodymium magnet motor.</p>
Nominal impedance	4ohm
Sensitivity 2.83V/1M	88dB
Power handling	80W(RMS)
Operating power	20-80W
Crossover	2,300Hz / 12dB
Frequency response	60/150-20,000Hz (-5dB)
Grille	Metal + fabric
Overall exterior grille dimensions (WxHxD/ Ø)	5.3" (135mm)
Cut out dimensions (HxW/ Ø)	4.92" (125mm)
Mounting Depth	3.15" (80mm)
Finish	white

## SoundWall™ POWERSLIM SERIES

Specifications	PMW600P	PMW600	PMC600
Construction	Front plastic ABS frame	Front plastic ABS frame	Front plastic ABS frame
Drive units	Woofer: 6.5" paper composite cellular fiber dome, 2.1" voice coil, neodymium magnet motor. Tweeter: 1.1" soft dome, neodymium magnet motor	Woofer: 6.5" carbon sandwich composite cellular fiber dome, 2.1" voice coil, neodymium magnet motor. Tweeter: 1.1" soft dome, neodymium magnet motor	Woofer: 6.5" endomax pearl composite cellular dome, 2.1" voice coil, pat pending neodymium zero point integra magnet motor structure. Tweeter: 1.1" soft dome, neodymium magnet motor
Nominal impedance	4ohm	4ohm	4ohm
Sensitivity 2.83V/1M	88dB	88dB	87dB
Power handling	90W(RMS)	100W(RMS)	80W(RMS)
Operating power	20-90W	20-100W	10-80W
Crossover	3,500Hz / 12dB	3,200Hz / 12dB	2,200Hz / 12dB
Frequency response	55-20,000Hz (-5dB)	50-20,000Hz (-5dB)	60-20,000Hz (-5dB)
Grille	Metal grille	Metal basalt grille	Metal basalt grille
Overall exterior grille dimensions (WxHxD/ø)	8.4"x11.8" (212x300mm)	8.4"x11.8" (212x300mm)	8.9" (228mm)
Cut out dimensions (HxW/ø)	7.3"x10.7" (185x273mm)	7.3"x10.7" (185x273mm)	8.1" (206mm)
Mounting Depth	1.6" (40mm)	1.6" (40mm)	1.6" (40mm)
Finish	white	white	white

## SoundWall™ CINEMA SERIES

Specifications	CW600	CW525LCR
Construction	Front plastic ABS frame	Front plastic ABS frame
Drive units	Woofer: 6.5" carbon fiber sandwich cone, external voice coil, with neodymium magnet motor. Tweeter: 1.1" aluminum hexatech voice coil, acuflex coated, neodymium magnet motor	Woofer: 5.25" double carbon fiber sandwich cone, external voice coil, with neodymium magnet motor. Tweeter: 1.1" aluminum hexatech voice coil, acuflex coated, neodymium magnet motor
Nominal impedance	4ohm	4ohm
Sensitivity 2.83V/1M	89dB	91dB
Operating power	120W(RMS)	150W(RMS)
Power handling	20-120W	20-150W
Crossover	4,500Hz / 12dB	4,000Hz / 12dB
Frequency response	45-20,000Hz (-5dB)	45-20,000Hz (-5dB)
Grille	Metal basalt grille	Metal basalt grille
Overall exterior grille dimensions (WxHxD/ø)	8.4"x11.8" (212x300mm)	16.6"x7.1"x0.1" (423x180x3mm)
Cut out dimensions (HxW/ø)	7.3"x10.7" (185x273mm)	6.1"x15.4" (154x390mm)
Mounting Depth	3.15" (80mm)	3.4" (85MM)
Finish	white	white